

# MUNICIPALITY OF Temagami

## APPENDIX '3'

### VACANT LANDS: TEMAGAMI NORTH

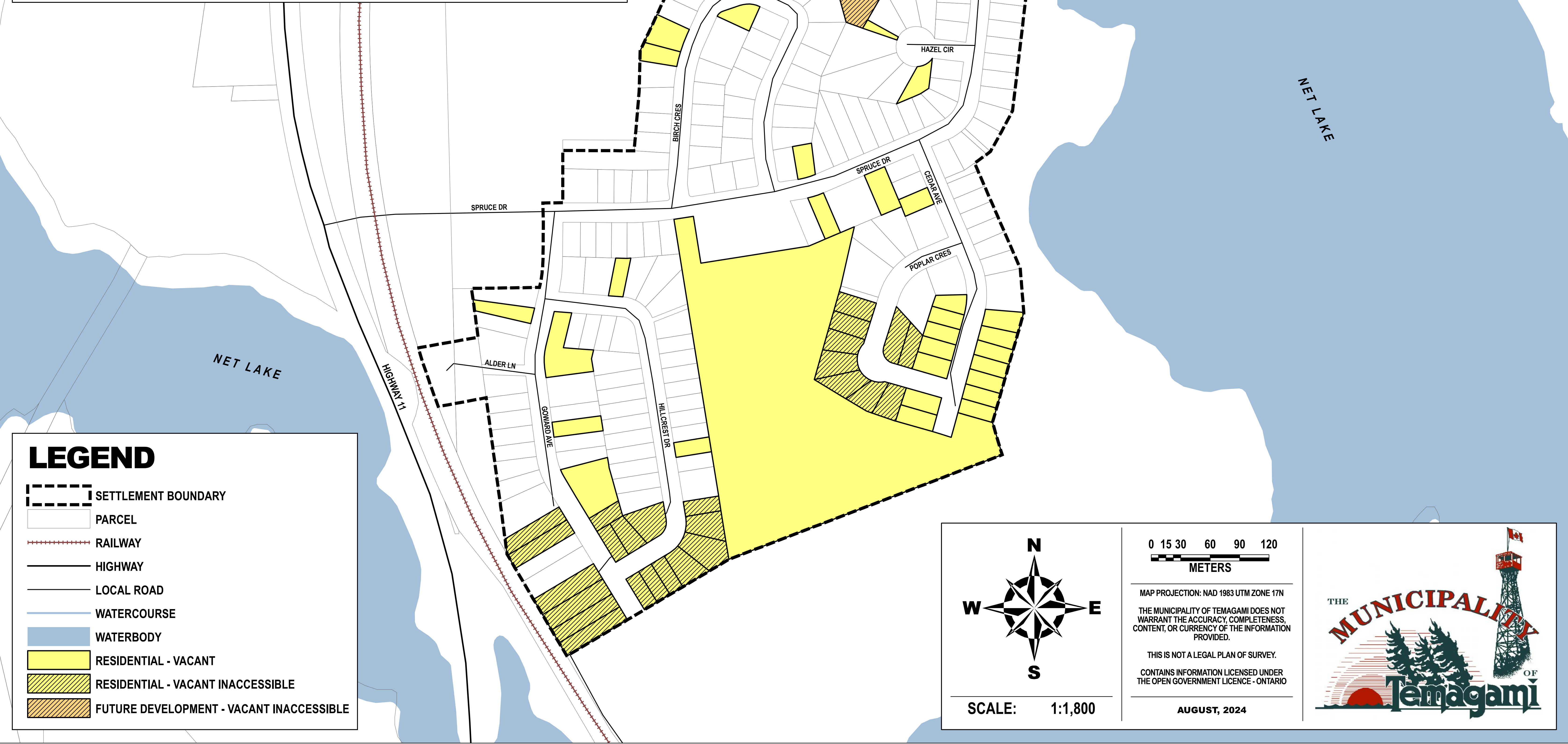

## LEGEND

- SETTLEMENT BOUNDARY
- PARCEL
- RAILWAY
- HIGHWAY
- LOCAL ROAD
- WATERCOURSE
- WATERBODY
- RESIDENTIAL - VACANT
- RESIDENTIAL - VACANT INACCESSIBLE
- FUTURE DEVELOPMENT - VACANT INACCESSIBLE

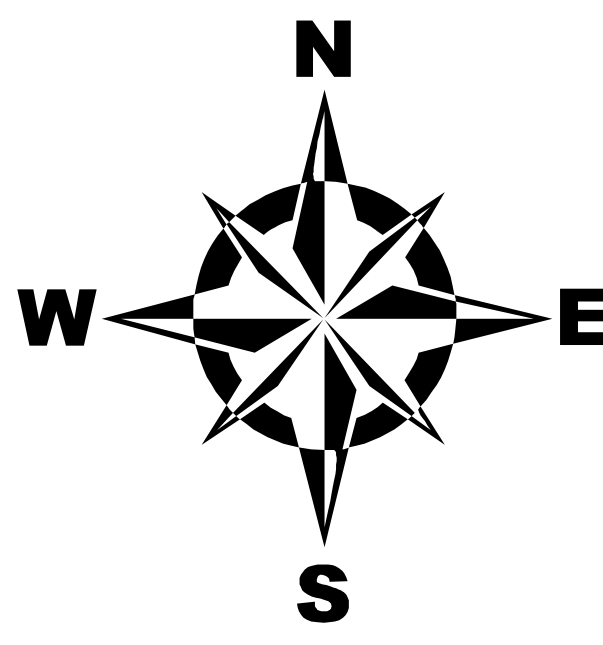

SCALE: 1:1,800

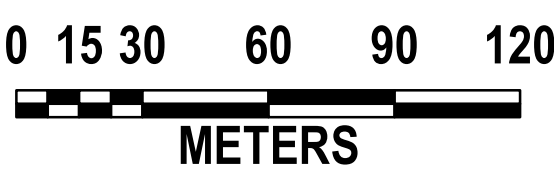

MAP PROJECTION: NAD 1983 UTM ZONE 17N

THE MUNICIPALITY OF TEMAGAMI DOES NOT WARRANT THE ACCURACY, COMPLETENESS, CONTENT, OR CURRENCY OF THE INFORMATION PROVIDED.

THIS IS NOT A LEGAL PLAN OF SURVEY.

CONTAINS INFORMATION LICENSED UNDER THE OPEN GOVERNMENT LICENCE - ONTARIO

AUGUST, 2024

