

Bylaw #1

THE CORPORATION OF THE MUNICIPALITY OF TEMAGAMI
BY-LAW NO. CQ-51: 2

A BY-LAW TO DESIGNATE A SITE PLAN CONTROL AREA ON CERTAIN LANDS IN THE GEOGRAPHIC TOWNSHIP OF JOAN NOW IN THE MUNICIPALITY OF TEMAGAMI, DISTRICT OF NIPISSING MORE PARTICULARLY DESCRIBED AS SUMMER RESORT LOCATION RW 3 BEING ISLAND 1022, IN LAKE TEMAGAMI AND DESIGNATED AS PARCEL 16859 IN THE PARCEL REGISTER FOR NIPISSING.

WHEREAS the Council of the Corporation of the Municipality of Temagami deems it desirable to designate a Site Plan Control Area in the Municipality of Temagami pursuant to Section 41 of the Planning Act, RSO 1990, C.P. 13;

AND WHEREAS the Council deems it desirable to delegate to the Clerk the authority to enter into an agreement respecting the matters referred to herein;

AND WHEREAS the Ministry of Municipal Affairs and Housing has approved a Minister's Zoning Order Amendment applying to the subject lands (Ontario Regulation No. 307/01) to permit the development of a tourist commercial use;

NOW, THEREFORE, THE COUNCIL OF THE CORPORATION OF THE MUNICIPALITY OF TEMAGAMI HEREBY ENACTS AS FOLLOWS:

1. DEFINITIONS

In this By-Law:

- 1.1 **Municipality** means the Municipality of Temagami.
- 1.2 **Council** means the municipal Council of the Municipality of Temagami.
- 1.3 **Development** means the construction, erection or placing of one or more buildings or structures on land including docks or storage sheds or the making of an addition or alteration to a building or structure that has the effect of increasing the size or usability thereof, or the laying out and establishment of private sewage disposal systems, or the grading or alteration in elevation or contour of land, but shall not include a private water supply and maintenance building.
- 1.4 **Dock Area** means the area where a floating, post supported or cantilevered dock shall be located.
- 1.5 **Private Water Supply and Maintenance Building** means a structure to enclose a water pump and associated accessories, and which is not suitable for human habitation, and for the purpose of this By-Law is not development as defined in this By-Law.
- 1.7 **Sewage Disposal System** means any system that is subject to the Ontario Building Code (Ont. Reg. 403/97 as amended) or its successors.
- 1.8 **Site Plan Control Area** means the area designated by Section 2 of this By-Law.
- 1.9 **Storage Shed** means an accessory building or structure which is designed or used for the storage of hand tools, equipment or materials incidental to a tourist commercial use, and which is not suitable for human habitation, and for the purpose of this By-law is development as defined in this By-law.

2. DESIGNATED LANDS

That certain area of land being Island 1022, in Lake Temagami, in the Municipality of Temagami, and which is more particularly designated as Parcel 16859, District of Nipissing as shown on Schedule 'A', attached hereto and forming part hereof, is hereby designated as a Site Plan Control Area.

3. SITE PLAN AGREEMENT

- 3.2 The location of the recommended dock locations as shown on Schedule 'B'.
- 3.3 The size, location and type of sewage disposal system leaching beds shall be as shown on Schedule 'B'.
- 3.4 The location of existing natural tree, shrub and ground vegetation to be retained as shown on Schedule 'B'.
- 3.5 The location of natural ground and shrub cover to be retained at the shoreline within view/access corridors as shown on Schedule 'B'.
- 3.6 The location of view/access corridors not exceeding 5 metres in width between the shoreline and cabin sites as shown on Schedule 'B'.
- 3.7 The location of trail routes connecting cabin sites and between cabin sites and the shoreline not exceeding 2 m in width shall be as shown on Schedule 'B'.
- 3.8 Provisions requiring that no portion of a sewage disposal system leaching bed discharging effluent to the soil shall be located or installed closer than 20 m from the high water mark as shown on Schedule 'B'.
- 3.9 Provisions requiring that the Owner maintain all natural tree, shrub and ground vegetation as shown on Schedule 'B' except where limited clearing is required to provide sites for building and structures, locations for sewage disposal leaching beds, trail routes, and access/view corridors to the shoreline in order to maintain and protect the natural aesthetics of the Lake Temagami landscape. Clearing around buildings and structures shall be limited to within 3 m of building walls.
- 3.10 Provisions that no alteration of soil mantles and no alteration in elevation or contour of the land shall be permitted except where site landscaping and clearing is required to provide sites for buildings and structures, safe access within trail routes and locations for sewage disposal leaching beds.
- 3.11 Provisions requiring that the Owner maintain access/view corridors where no removal of natural flora ground cover or low shrubs is permitted within 3 m of the shoreline in order to maintain and protect riparian shrub vegetation.
- 3.12 Provisions specifying a timing restriction that no dock placement or construction or other in-water work be undertaken from May 15 to July 15 in order to protect potential smallmouth bass spawning.
4. This By-Law shall come into force 17 APRIL 2002

READ A FIRST AND SECOND TIME on this (7th) day of April, 2002.

READ A THIRD and final time and passed this/1st day of April 2002.

Wayne Adams, Mayor

John Hodson, C.A.O.

CORPORATE SEAL

SITE PLAN

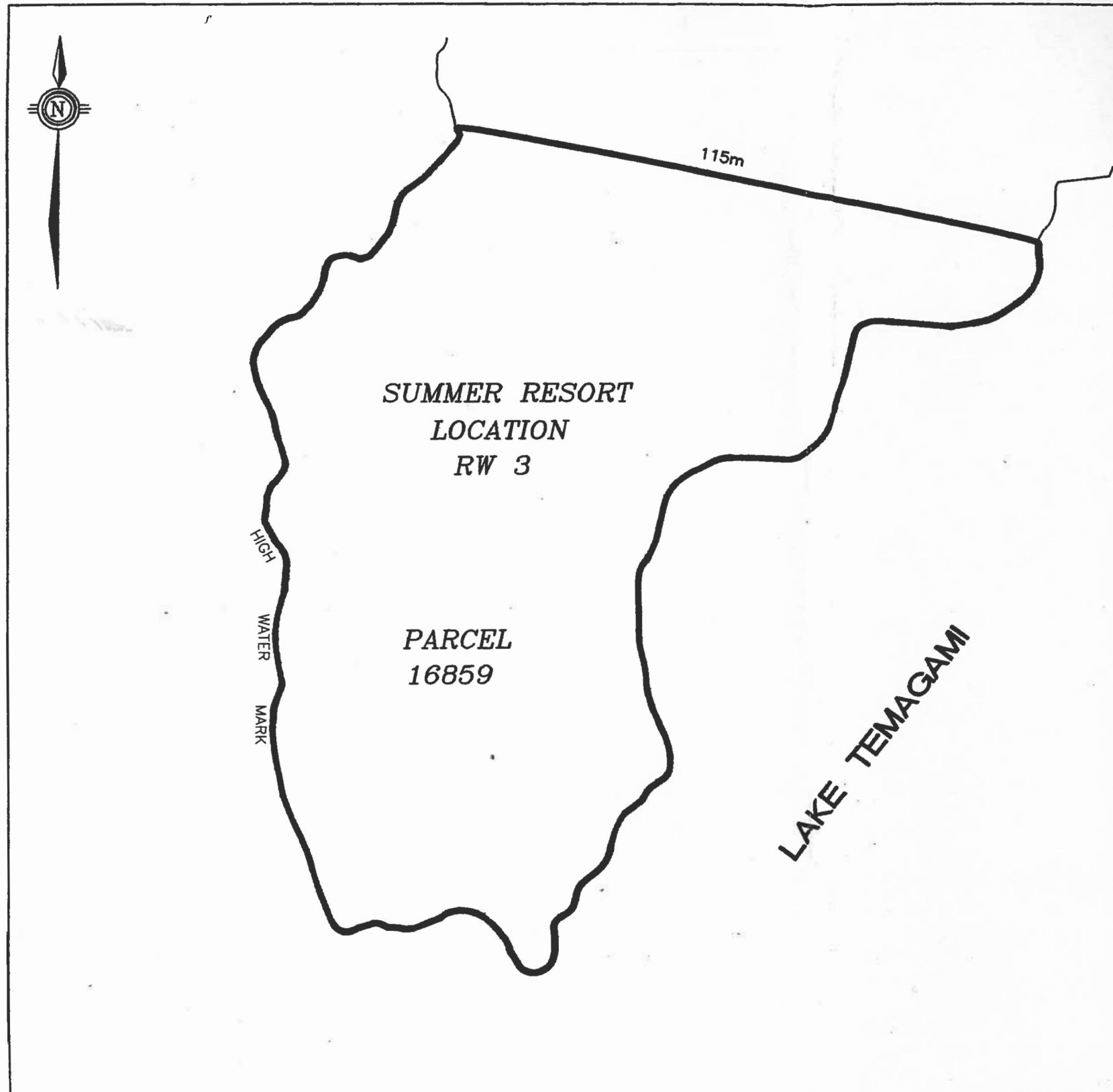

TO IS SCHEDULE 'A'
TO SITE PLAN CONTROL AGREEMENT AUTHORIZED BY
BY-LAN No/SZ-^I PASSED TOE /7^
DAYOF/^IC, 2002.

SUMMER RESORT LOCATION RW 3
PART OF ISLAND 1022
LAKE TEMAGAMI

JXGEND



AREA SUBJECT TO SITE PLAN CONTROL

NOTES:

UNIT OF THE HIGH WATER MARK OF LAKE
TEMAGAMI AS SHOWN ON PATENTS PLAN
SUMMER RESORT LOCATION RW 3
PREPARED BY W.J. RYAN O.L.S. ON
AUG. 25. 1950.

SCALE: 1-1000

PROJECT No. 4419
DATE: SEPT. 1999

RICK LOCKHART, OWNER

PAULINE LOCKHART, OWNER

WAYNE ADAIR, MAYOR

JOHN HODGSON, C.A.O.

northland
engineering
limited
Consulting Engineers and Planners
NORTH END



CAGgl^ji^ASE



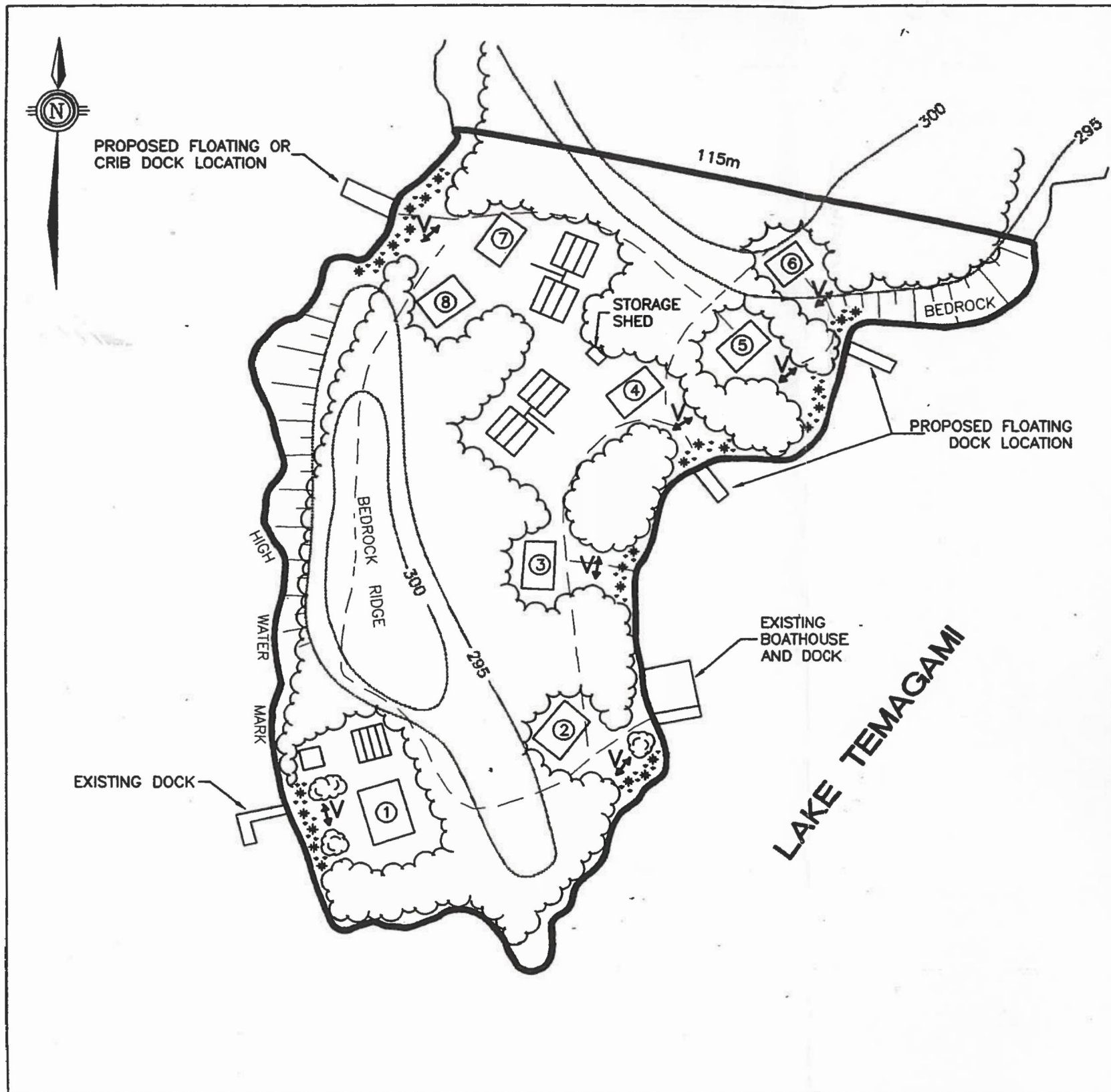

SITE PLAN

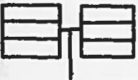
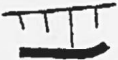

THIS IS SCHEDULE 'B'
TO SITE PLAN CONTROL AGREEMENT AUTHORIZED BY
BY-LAW No. 02-527 PASSED THE 17th
DAY OF APRIL 2002.

SUMMER RESORT LOCATION RW 3
PART OF ISLAND 1022
LAKE TEMAGAMI

LEGEND

- 
HOUSEKEEPING CABIN
(NOT TO BE LOCATED CLOSER THAN
15m FROM HIGH WATER MARK)
- 
FILTER BED SEWAGE DISPOSAL SYSTEM
(NOT TO BE LOCATED CLOSER THAN
20m FROM HIGH WATER MARK)
- 
STEEP BEDROCK SHORELINE
- 
**NATURAL SHORELINE SHRUB AND GROUND
VEGETATION TO BE RETAINED WITHIN
VIEW CORRIDOR (3m MIN. BUFFER WIDTH)**
- 
**NATURAL TREE, SHRUB AND GROUND
VEGETATION TO BE RETAINED**
- 
TRAIL ROUTE
(NOT TO EXCEED 2m IN WIDTH)
- 
VIEW/ACCESS CORRIDOR
(NOT TO EXCEED 6m IN WIDTH)
- 5

NOTES:

LIMIT OF THE HIGH WATER MARK OF LAKE
TEMAGAMI AS SHOWN ON PATENTS PLAN
SUMMER RESORT LOCATION RW 3
PREPARED BY W.J. RYAN O.L.S. ON
AUG. 25, 1950.

SCALE : 1:1000

PROJECT No. 4419
DATE: SEPT. 1999

REVISÉ : JAN. 2000

RICK LOCKHART, OWNER

PAULINE LOCKHART, OWNER

WAYNE ADAMS, MAYOR

JOHN HODGSON, C.A.O.

northland
engineering
limited



Consulting Engineers and Planners

CADFILE 4419-BASE